

### ECONODECK CLIP FIXING

1. ECONODECK CLIP IS FITTED OVER UPTURNED EDGE/SEALANT STRIP & THEN SCREWED TO PURLIN.
2. NEXT PANEL IS FITTED OVER CLIP & UPTURNED EDGE, SLIP-JOINTS ARE THEN ENGAGED.
3. THE EXPOSED PORTION OF CLIP IS THEN FOLDED BACK OVER THE RIB.
4. ALL RIBS ARE THEN BUTTON-PUNCHED TO WEATHER SEAL THE ROOF.

### OTHER OPTION:

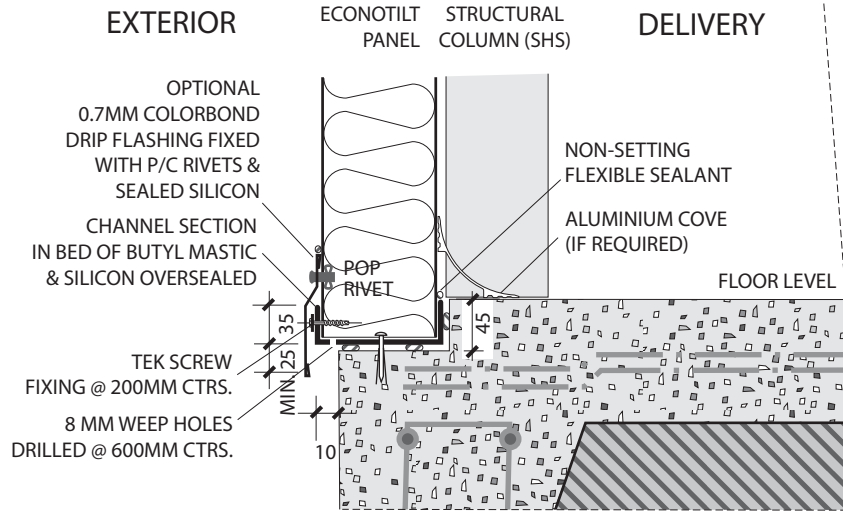
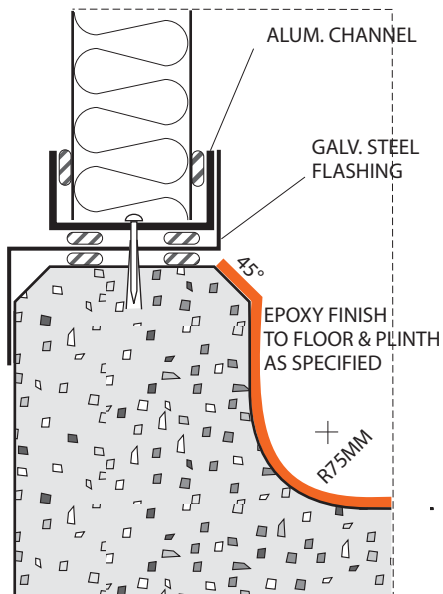

Note: Base fixings can be varied as shown in Refrigerated Applications - see Drng. B3



THIS DRAWING IS THE PROPERTY OF AUSTRAL INSULATION AND MAY NOT BE REPRODUCED IN WHOLE OR IN PART WITHOUT THEIR PRIOR WRITTEN CONSENT.

ALL COPYRIGHT RESERVED.

## INSULATED DETAILS Econotilt™ & Econodeck® Panel EXTERNAL BASE/WALL/ROOF

Drawn	SDH
Date	17.03.08
Rev.	23.07.08
Drng. N <sup>o</sup> .	A2